

REVISION HISTORY				
REV	DATE	DESCRIPTION	ECO	BY
A	04/03/2012	PRODUCTION RELEASE	13859	SV
B	3/13/2013	REMOVED: 110-3444 ; ADDED: 711-3355	14133	SV

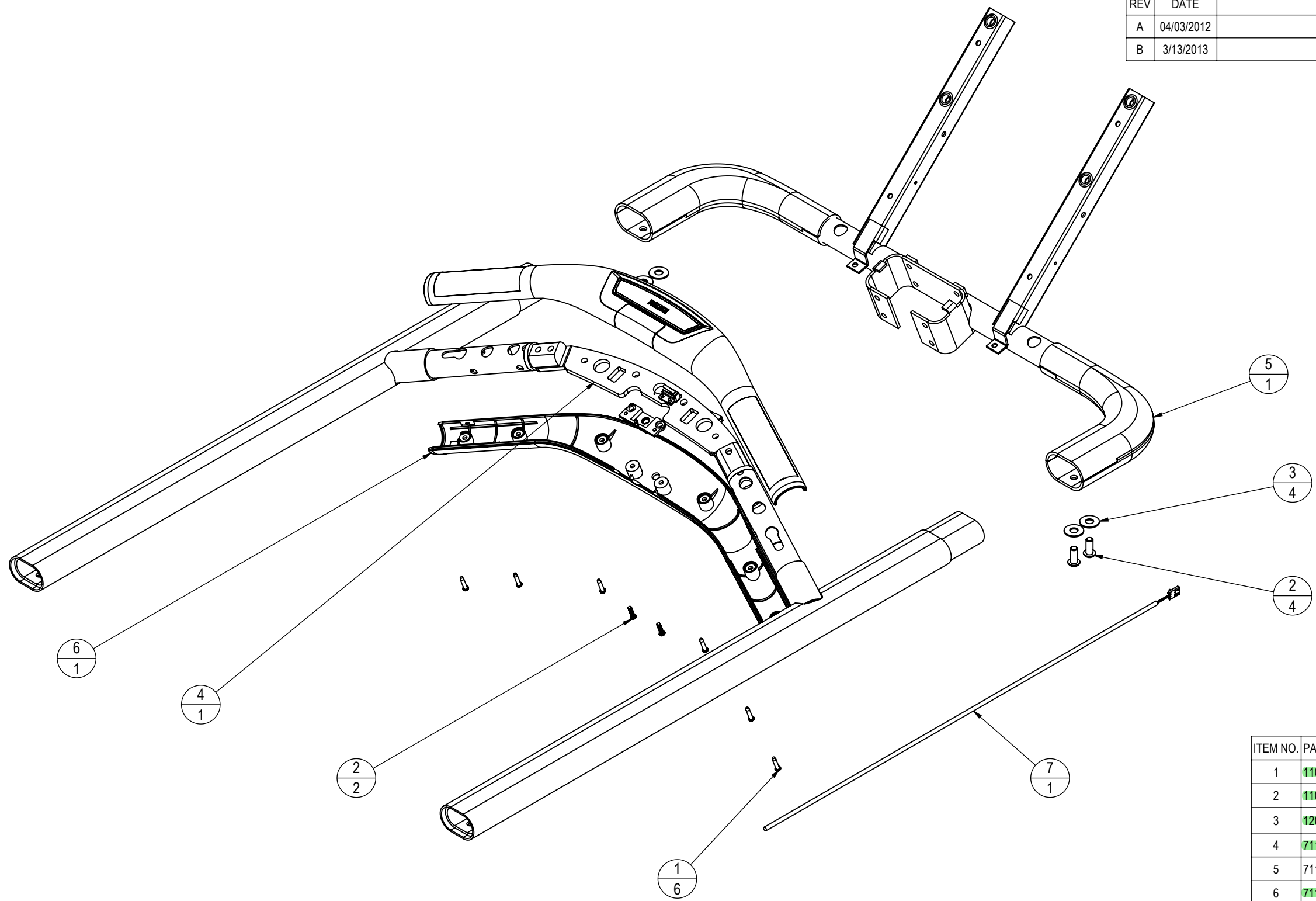

ITEM NO.	PART NUMBER	DESCRIPTION	QTY
1	110-3402	SCREW, M4x0.7x19L,PHT,PH,CS,BZ	6
2	110-3510	SCREW, 5/16-18, 3/4", BHCS, AS, ECB	4
3	120-3330	WASHER, PLAIN, ID: .375", OD: .875", TH: .06", CS, ECB	4
4	711-3293	WELDMENT, HANDRAIL, STARMILL	1
5	711-3301	WELDMENT, DISP SUPPORT, STARMILL	1
6	711-3345	WARM BAR, MECH. ASSY, E-SM	1
7	711-3355	CABLE, POWER TO CCB, E-SM	1

DOCUMENT STATUS:

NOTICE OF PROPRIETARY INFORMATION
 THIS DOCUMENT SHALL NOT BE REPRODUCED NOR SHALL THE INFORMATION CONTAINED HEREIN BE USED BY OR DISCLOSED TO OTHER EXCEPT AS EXPRESSLY AUTHORIZED BY CORE INDUSTRIES, INC., D.B.A. STAR TRAC.

MATERIAL SEE BOM	THIRD ANGLE PROJECTION		CORE INDUSTRIES, INC. DBA STAR TRAC 14410 Myford Road Irvine CA 92606
	DRAWN	DATE	
FINISH SEE BOM	INITIAL	DATE	STARTRAC PART NO
	CHECKED	04/03/2012	711-3292
VENDOR: LAND AMERICA	APPROVED		TITLE
			HANDRAIL, HEARTRATE, STARMILL
P/N:	U.O.M.	SCALE: 1:5	SHEET 1 OF 1
			SHEET SIZE: B